

**GP041-0093,2**



1/1



PB  
1X

PC  
1X

PD  
1X

PE  
1X

PO  
1X

PO1  
2X

PO2  
2X

PY  
1X

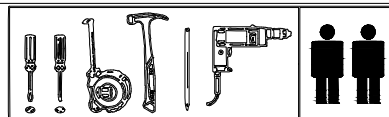

PB 400x350 mm

PC 400x350 mm

PD 344x349 mm

PE 344x349 mm

PO 362x64 mm

PO1 362x64 mm

PO2 278x64 mm

PY 396x378 mm

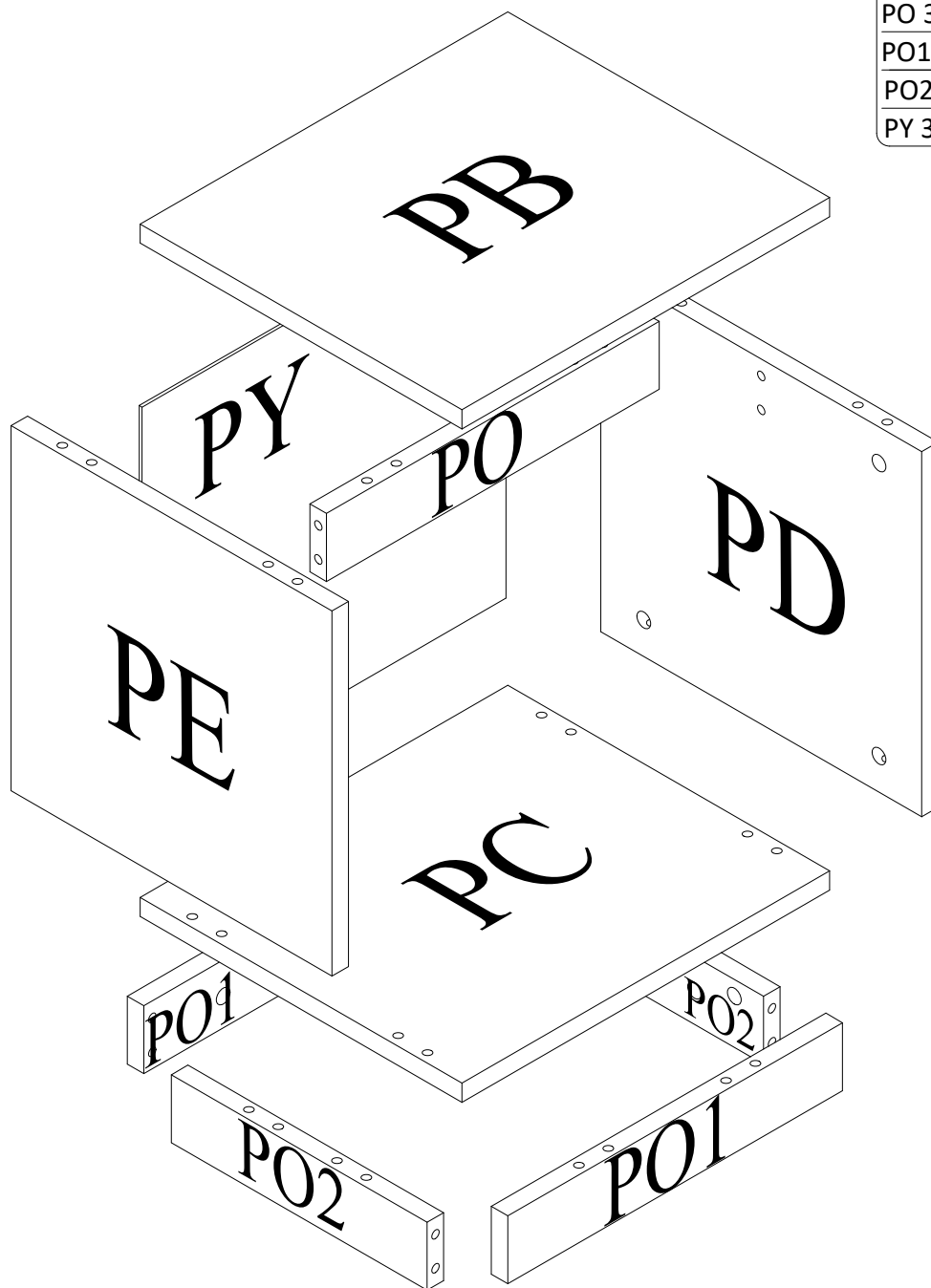

NO: H100023

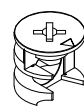

22 X

NO: H100024



22 X

NO: P000101

Ø8 x 34 MM

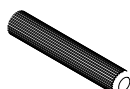

26 X

NO: H100069



04 X

NO: H100039



15 X

NO: H100050

18 MM



08 X

